

Smart multifunction knob

Technical parameters

- Clean surface, uniform gloss
- Rated voltage: 12V
- LED rated load: 3V
- LED lamp beads color
- Lamp-socket material: ABS, Stainless steel, Plastic, Zinc alloy
- Lamp surface treatment: chrome treatment
- 3014 lamp beads specifications
- Forward current=30mA
- Voltage=2.8-3.6V
- Color rendering index=65-85
- Luminous flux=9-12LM
- Power=0.1W
- Life=50000H
- Size=3.0(length)x1.4(width)x0.8(thickness)
- High quality materials, zinc alloy, stainless steel and plastic

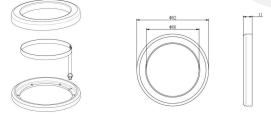

Smart multifunction knob

Technical parameters

- Clean surface, uniform gloss
- Rated voltage: 12V
- LED rated load: 3V
- LED lamp beads color
- Lamp-socket material: ABS, Stainless steel, Plastic, Zinc alloy
- Lamp surface treatment: chrome treatment
- 3014 lamp beads specifications
- Forward current=30mA
- Voltage=2.8-3.6V
- Color rendering index=65-85
- Luminous flux=9-12LM
- Power=0.1W
- Life=50000H
- Size=3.0(length)x1.4(width)x0.8(thickness)
- AC/DC Universal voltage

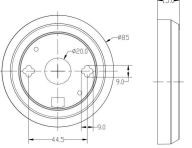
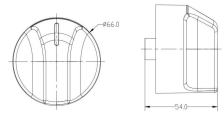

LED Knob Light



USA J&V TRADING LLC
 15738 E valley Blvd City of Industry CA 91714
 +1 626 872 0098
 Sales: Mr.jacky_zhang
 www.overseas.com
 www.badebur.com

J&V Electronic Science and Technology Co., Ltd
 ADD: Zhang Yang FuDa Road 8# Zhangshu Town Dongguan City Guangdong Province China
 Sales: Mr.jacky_zhang
 Tel: +86 0769 85500056
 Fax: +86 0769 85500157
 Mobile: +86 018688880255
 E-mail: jacky_zhang@jv.com
 Website: http://www.jv.com

ABOUT US

J&V Electronic Science and Technology Co., Ltd. is specialized in designing and producing lighting lamps of home appliances, kitchen appliances lighting systems, gas appliances safety control parts and electronic control technology application parts. J&V has become world's leading brand on high temperature lighting lamps and kitchen appliances parts industry.

Main products are lighting lamps of ovens, barbecue grills, range hoods, refrigerators, fireplaces and hearths, LED knob lights, indicator lights, gas flameout protection devices, appliances controllers, appliances metal switches and customize home appliances wiring harness. The annual production capacity is approximately 20 million sets. The products have passed Australian, Chinese, American and European certification, such as SAA, CSA, UL, TUV, CE and CQC. Besides, a number of patents are owned in North America and Europe.

J&V has first-class production equipments, advanced production process and fully-equipped detecting instruments and testing equipments. With the strength of technological innovation, research the products independently, in addition to rich experiences in manufacturing. Consequently, related lighting, appliances controlling and electronic safety system of ovens, stoves, barbecue grills, fireplace, steamers, oven stoves, range hoods can be designed and manufactured in the company based on customers' specific requirements. J&V will unceasingly provide customers quality products and services, continue leading the industry standard.

Smart multifunction knob

Our Company Feature is Brands Customize Services! We can give you a unique design, Exclusive to your product! Our knobs are available in various styles and colors.

Technical parameters

- Clean surface, uniform gloss
- Rated voltage: 12V
- LED rated load: 3V
- LED lamp beads color
- Lamp-socket material: ABS, Stainless steel, Plastic, Zinc alloy
- Lamp surface treatment: chrome treatment
- 3014 lamp beads specifications
- Forward current=30mA
- Voltage=2.8-3.6V
- Color rendering index=65-85
- Luminous flux=9-12LM
- Power=0.1W
- Life=50000H
- Size=3.0(length)x1.4(width)x0.8(thickness)

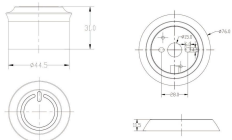

Smart multifunction knob

When turning the knob, There will be two or more colors alternately (Note: Customers can also choose or customize according to their own needs and preferences).

Technical parameters

- Clean surface, uniform gloss
- Rated voltage: 12V
- LED rated load: 3V
- Waterproof cover: PC
- Lamp-socket material: ABS, Stainless steel, Plastic, Zinc alloy
- Lamp surface treatment: Nickel-plated wire drawing
- 3014 lamp beads specifications
- Forward current=30mA
- Voltage=2.8-3.6V
- Color rendering index=65-85
- Luminous flux=9-12LM
- Power=0.1W
- Life=50000H
- Size=3.0(length)x1.4(width)x0.8(thickness)

